

Connectors for Copper Conductor

Two-Hole Lugs — Long Barrel 600V to 35KV

Material: High-Conductivity Wrought Copper

Finish: Electro Tin Plate

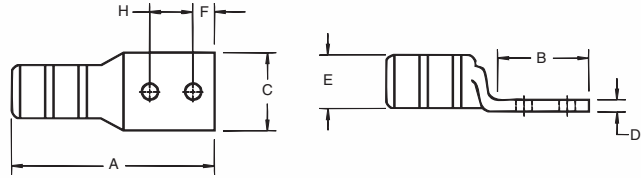

Peep Holes Available!
Add suffix -PH



Color-Keyed Compression

| CAT. NO. | WIRE SIZE | | | DIMENSIONS (IN.) | | | | | | | | DIE CODE | DIE COLOR |
|-----------------|------------|----------------------|----------------|------------------|------|------|-----|-----|-----|----|----|----------|-----------|
| | CODE | FLEX CLASS | G, H, I, K, M† | BOLT SIZE | A | B | C | D | E | F | H | | |
| 54801BE | #14-10 AWG | | | ¼ | 1.86 | 1.19 | .50 | .05 | .20 | ¼ | ¾ | ERG2002 | YELLOW |
| 256-31426-3 | #14-10 AWG | | | #10 | 2.00 | 1.25 | .37 | .07 | .20 | ¼ | ¾ | ERG2002 | YELLOW |
| 256-31426-3SPH | #14-10 AWG | | | #10 | 2.00 | 1.25 | .37 | .07 | .20 | ½ | ¾ | ERG2002 | YELLOW |
| 256-30695-1298 | #14-10 AWG | | | ¼ | 1.89 | 1.22 | .50 | .05 | .20 | ¼ | ¾ | ERG2002 | YELLOW |
| 256-30695-1730 | #14-10 AWG | | | ¼ | 1.98 | 1.31 | .50 | .05 | .20 | ¼ | ¾ | ERG2002 | YELLOW |
| 54850BE | #8 AWG | 37/24 = 14.9 kcmil | | ¼ | 2.19 | 1.89 | .42 | .07 | .26 | ¼ | ¾ | 21 | RED |
| 54851BE | #8 AWG | #8 Weld | | ¼ | 2.31 | 1.29 | .47 | .06 | .26 | ¼ | ¾ | 21 | RED |
| 256-30695-1157 | #8 AWG | | | ¾ | 3.00 | 2.10 | .56 | .06 | .26 | ¾ | 1 | 21 | RED |
| 54852BE | #6 AWG | | | ¼ | 2.28 | 1.28 | .44 | .08 | .30 | ¼ | ¾ | 24 | BLUE |
| 256-30695-1014 | #6 AWG | | | ¼ | 2.63 | 1.63 | .43 | .08 | .30 | ¼ | 1 | 24 | BLUE |
| 256-30695-1225 | #6 AWG | 61/24 = 24.6 kcmil | | ¼ | 2.43 | 1.43 | .43 | .08 | .30 | ¼ | ¾ | 24 | BLUE |
| 256-30695-1158 | #6 AWG | #6 Weld | | ¾ | 2.93 | 1.93 | .59 | .06 | .30 | ¾ | 1 | 24 | BLUE |
| 256-30695-868 | #6 AWG | | | ½ | 4.18 | 3.00 | .88 | .11 | .30 | ½ | 1¾ | 24 | BLUE |
| 54854BE | #4 AWG | | | ¼ | 2.31 | 1.19 | .52 | .10 | .37 | ¼ | ¾ | 29 | GRAY |
| 256-30695-1246 | #4 AWG | | | ¼ | 2.31 | 1.31 | .56 | .09 | .37 | ¼ | ¾ | 29 | GRAY |
| 256-30695-1015 | #4 AWG | 91/24 = 36.7 kcmil | | ¼ | 2.88 | 1.88 | .58 | .09 | .37 | ¾ | 1 | 29 | GRAY |
| 256-30695-1337 | #4 AWG | #4 Weld | | ⅝ | 2.75 | 1.75 | .56 | .10 | .37 | 1½ | 1 | 29 | GRAY |
| 256-30695-1159 | #4 AWG | | | ¾ | 3.13 | 1.98 | .59 | .09 | .37 | ¾ | 1 | 29 | GRAY |
| 256-30695-733 | #4 AWG | | | ½ | 4.18 | 3.00 | .88 | .09 | .37 | ½ | 1¾ | 29 | GRAY |
| 256-30695-1016 | #2-3 AWG | | | ¼ | 3.06 | 1.88 | .67 | .09 | .41 | ¾ | 1 | 33 | BROWN |
| 54855BE | #2-3 AWG | | | ¼ | 2.43 | 1.28 | .59 | .11 | .41 | ¼ | ¾ | 33 | BROWN |
| 256-30695-1300 | #2-3 AWG | | | ¼ | 2.63 | 1.35 | .68 | .11 | .41 | ¼ | ¾ | 33 | BROWN |
| 54856BE | #2-3 AWG | | | ⅝ | 2.78 | 1.63 | .59 | .11 | .41 | ¾ | ¾ | 33 | BROWN |
| 54810BE | #2-3 AWG | 125/24 = 50.4 kcmil | | ¾ | 3.80 | 2.57 | .59 | .11 | .41 | ¾ | 1¾ | 33 | BROWN |
| 256-30695-1160 | #2-3 AWG | | | ¾ | 3.08 | 1.94 | .59 | .11 | .41 | ¾ | 1 | 33 | BROWN |
| 256-30695-869 | #2-3 AWG | | | ½ | 4.02 | 2.88 | .75 | .09 | .41 | ¾ | 1¾ | 33 | BROWN |
| 54811BE | #2-3 AWG | | | ½ | 4.28 | 3.00 | .88 | .11 | .41 | ½ | 1¾ | 33 | BROWN |
| 54809BE | #1 AWG | | | ¼ | 2.88 | 1.19 | .67 | .11 | .47 | ¼ | ¾ | 37 | GREEN |
| 54812BE | #1 AWG | 150/24 = 60.5 kcmil | | ¼ | 2.75 | 1.40 | .67 | .11 | .47 | ¼ | ¾ | 37 | GREEN |
| 54858BE | #1 AWG | 175/24 = 70.6 kcmil, | | ⅝ | 2.97 | 1.63 | .67 | .11 | .47 | ¾ | ¾ | 37 | GREEN |
| 256-30695-1161 | #1 AWG | #2 Weld | | ¾ | 3.30 | 1.98 | .67 | .11 | .47 | ¾ | 1 | 37 | GREEN |
| 54857BE | #1 AWG | | | ½ | 4.43 | 3.00 | .88 | .11 | .47 | ½ | 1¾ | 37 | GREEN |
| 256-30695-1018 | 1/0 AWG | | | ¼ | 3.63 | 1.88 | .75 | .13 | .52 | ¾ | 1 | 42 | PINK |
| 256-30695-1018P | 1/0 AWG | | | ¼ | 3.63 | 1.88 | .75 | .13 | .52 | ¾ | 1 | 42 | PINK |
| 54859BE | 1/0 AWG | | | ¼ | 2.63 | 1.19 | .75 | .13 | .52 | ¼ | ¾ | 42 | PINK |
| 54813BE | 1/0 AWG | | | ¼ | 2.71 | 1.38 | .75 | .13 | .52 | ¼ | ¾ | 42 | PINK |
| 54860BE | 1/0 AWG | 225/24 = 90.8 kcmil | | ⅝ | 2.97 | 1.63 | .75 | .13 | .52 | ¾ | ¾ | 42 | PINK |
| 256-30695-1162P | 1/0 AWG | | | ¾ | 3.25 | 1.98 | .75 | .13 | .52 | ¾ | 1 | 42 | PINK |
| 256-30695-1162 | 1/0 AWG | | | ¾ | 3.23 | 1.93 | .75 | .13 | .52 | ¾ | 1 | 42 | PINK |
| 256-30695-593 | 1/0 AWG | | | ¾ | 4.33 | 3.00 | .75 | .13 | .52 | ¾ | 1¾ | 42 | PINK |

† Contact Technical Services for specific stranding listings

Tooling: pp. B76-B92 Die Selector Chart: pp. B93-B95

United States
Tel: 901.252.8000
800.816.7809
Fax: 901.252.1354

Canada
Tel: 450.347.5318
Fax: 450.347.1976

Technical Services
Tel: 888.862.3289

Thomas & Betts

www.tnb.com